

Employee Stock Purchase Plan (ESPP) Enrollment

Overview

To access the ESPP enrollment site, go to etrade.com/enroll. Follow the steps below to complete your enrollment.

1. If you have an existing E*TRADE account: Click on the purple **Log on** button and enter your user ID and password. If you do not have an existing E*TRADE account, you may be asked to enter your company's **Ticker Symbol**, **Last Name**, and **Social Security number** (or Employee ID #) to set up your account before moving forward with ESPP enrollment.

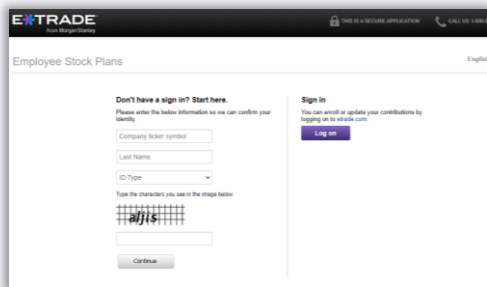

2. Navigate to **Plan Elections** by going to **At Work > My Account > Plan Elections**. Click **Enroll** next to your ESPP offering period.

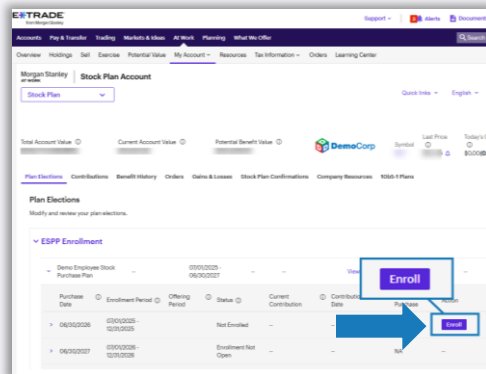

3. On the pop-up screen you can¹:
 - Set or modify your contribution amount²
 - Suspend contributions
 - Withdraw from the plan
 - Review current or past enrolment informationReview your changes and click **Continue** to preview and confirm your enrolment.

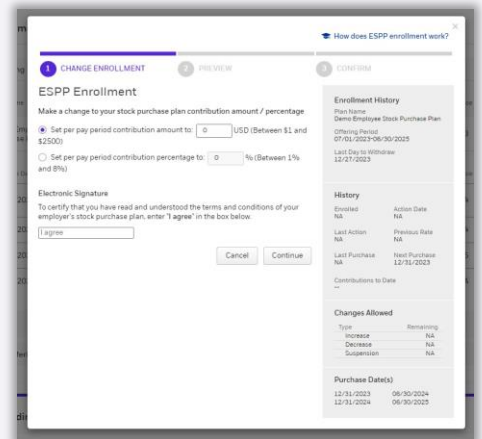

¹ Depending on your settings, you may be prompted to activate your account if you haven't done so already. Not all actions that are possible on this page are allowed by all companies.

² The contribution amount/percentage will vary by countries. Your enrollment site will reflect the election amount/percentage as applicable for your jurisdiction.

Have Questions?

If you have difficulty accepting your grant, please contact E*TRADE at (800) 838-0908, 24 hours a day on weekdays. (If you are outside the US, visit etrade.com/contact for your country's toll-free number.)

Employee stock plan solutions are offered by E*TRADE Financial Corporate Services, Inc., Solium Capital LLC, Solium Plan Managers LLC and Morgan Stanley Smith Barney LLC ("MSSB"), which is part of Morgan Stanley at Work.

Morgan Stanley at Work services and stock plan accounts are provided by wholly owned subsidiaries of Morgan Stanley.

Morgan Stanley at Work stock plan accounts were previously referred to as Shareworks, StockPlan Connect or E*TRADE stock plan accounts, as applicable.

In connection with stock plan solutions offered by Morgan Stanley at Work, securities products and services are offered by MSSB, Member [SIPC](#).

E*TRADE from Morgan Stanley is a registered trademark of MSSB.

All entities are separate but affiliated subsidiaries of Morgan Stanley.

Content and services available to non-US participants may be different than those available to US participants.

The laws, regulations, and rulings addressed by the products, services, and publications offered by Morgan Stanley and its affiliates are subject to various interpretations and frequent change. Morgan Stanley and its affiliates do not warrant these products, services, and publications against different interpretations or subsequent changes of laws, regulations, and rulings. Morgan Stanley and its affiliates do not provide legal, accounting, or tax advice. Always consult your own legal, accounting, and tax advisors.

© 2025 Morgan Stanley. All rights reserved.

CRC 4829782 10/2025